

---

*Comfort-Cire*®

**Century**®

---

PARTS LIST

**Inverter Single Zone  
Ductless Mini-Split  
Indoor Ceiling Cassette Panel**

B-VMH24CV-1

# EXPLODED VIEW

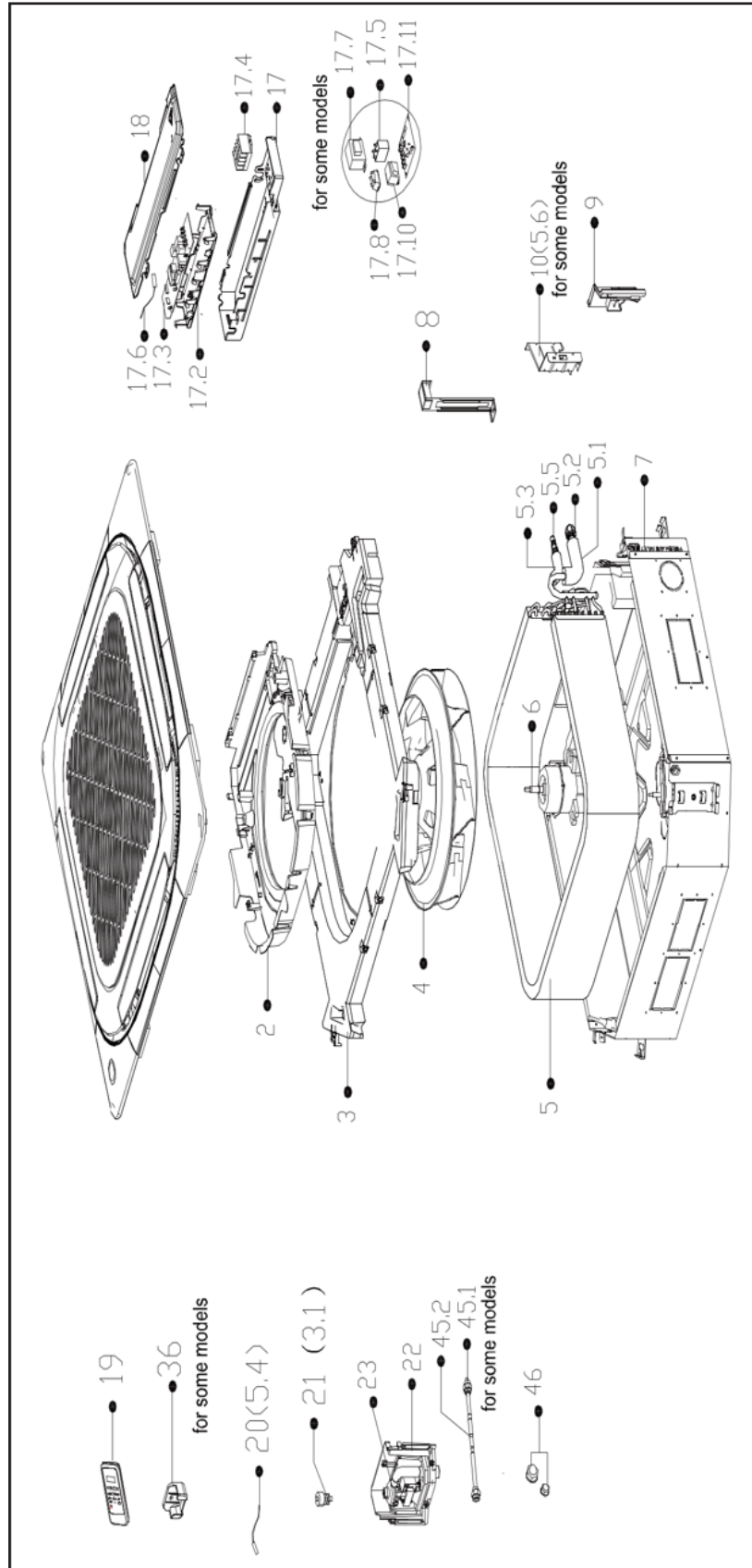

## REPLACEMENT PARTS

Location	Part Name	Quantity	Part No.
2	Ventilation ring	1	12122500002031
3	Water collector subassembly	1	12822500000450
3.1	Water Level Switch	1	17400511001044
4	centrifuge fan	1	12100103000149
5	Evaporator assembly	1	15822500002359
5.1	Evaporator outlet pipe subassembly	1	15122500003156
5.2	Pipe Nut	1	15500404000005
5.3	Evaporator inlet pipe subassembly	1	15122500003237
5.4	Pipe Temperature Sensor	1	11201007003442
5.5	Detection Valve	1	15500209000002
6	Brushless DC Motor	1	11002015012268
7	Chassis assembly	1	12222500002035
8	Evaporator fixing hanger	1	12222500000084
9	Pipe fixing board subassembly	1	12122500002028
10	Evaporator fixing board subassembly	1	12222500001673
17	Electronic control box subassembly	1	17222500003400
17.2	Insulation Plate	1	12122500002047
17.3	Main control board subassembly	1	17122500005245
17.4	Terminal	1	17400401000032
17.6	Room Temperature Sensor	1	11201007003424
17.7	Reactor	1	174003060000923
17.11	Humidity sensor subassembly	1	17122000048868
18	Electric Control Box Cover	1	12222500002033
19	Remote controller	1	17317000A65524
22	External Water Pump Box Assembly	1	12122500002027
23	Induction Pump	1	11001010001757
36	Bracket of remote Controller	1	12122000029201
41	Accessory kit	1	12011600005258
46	Copper nut	1	15500406000003
46	Copper nut	1	15500406000010

---

Due to ongoing product improvements, specifications and dimensions are subject to change and correction without notice or incurring obligations. Determining the application and suitability for use of any product is the responsibility of the installer. Additionally, the installer is responsible for verifying dimensional data on the actual product prior to beginning any installation preparations.

Incentive and rebate programs have precise requirements as to product performance and certification. All products meet applicable regulations in effect on date of manufacture; however, certifications are not necessarily granted for the life of a product. Therefore, it is the responsibility of the applicant to determine whether a specific model qualifies for these incentive/rebate programs.

*Comfort-Aire*® **Century**®

1900 Wellworth Ave., Jackson, MI 49203 • Ph. 517-787-2100 • [www.marsdelivers.com](http://www.marsdelivers.com)

